

SPECIFICATION:

1. ELECTRICAL
 - 1.1 Current Rating: 0.5A per pin
 - 1.2 Voltage Rating: 50V DC
 - 1.3 Contact Resistance: 5.5mΩ Max
 - 1.4 Insulation Resistance: 500MΩ Min
 - 1.5 Dielectric Withstanding Voltage: 300VAC

2. MECHANICAL

- 2.1 Durability: 100 Cycle
- 2.2 Insertion Force: 2.3Kgf max.
- 2.3 Extraction Force: 2.3Kgf max.

3. ENVIRONMENTAL

- 3.1 Operating temperature range: -40 °C ~ +85 °C
- 3.2 Storage temperature range: -40 °C ~ +85 °C

4. SOLDER ABILITY

- 4.1 Recommended IR Reflow Temperature: 260 °C 10Sec

NOTE: 1

DATE CODE: 3 3 4 1
 YEAR 2013 DAY 1 AT WEEK 34

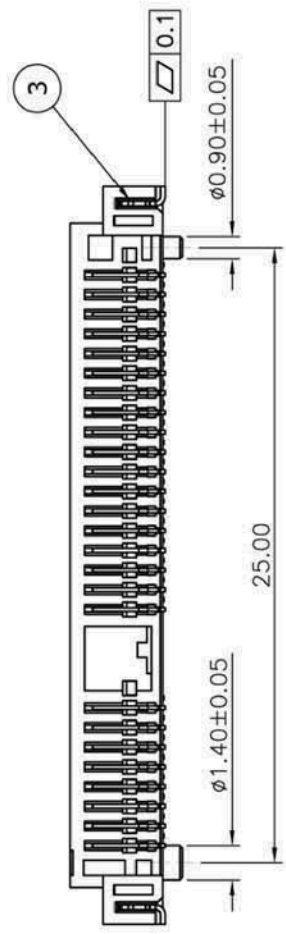
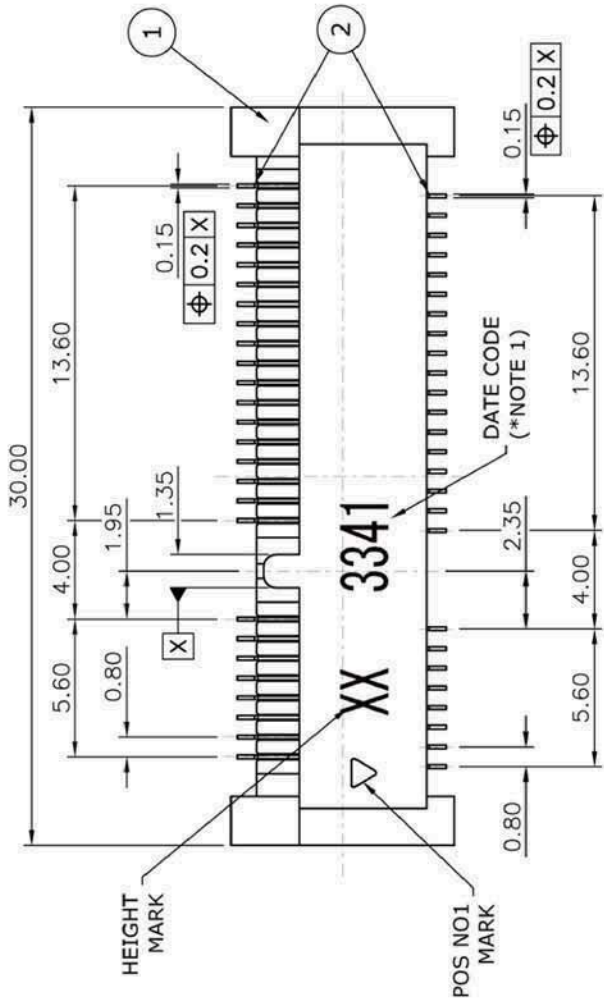
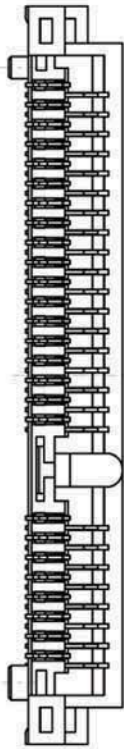
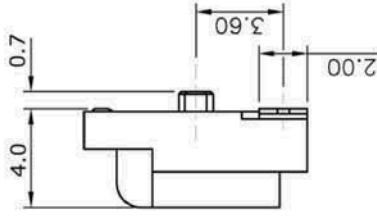

ORDER INFORMATION

MPCIH1 S1 - 052 N G 2 R - COD

1. SERIES NO. MPCIH1 Mini PCI H=4.0mm
2. TERMINAL VERSION S1: SMT Type
3. NO. OF CONTACTS 52
4. INSULATOR COLOR NiBlack
5. CONTACT PLATING 6: Gold Flash
6. PACKAGING 2: Tape & Reel
7. R: RoHS

GENERAL TOLERANCE

DECIMAL	LINEAR	ANGLES
X.	±0.50	±5°
X.X	±0.25	±3°
X.XX	±0.12	±1°

SIZE	DRAWN
A4	Sarm
REV.	DATE
0	08/11/15



UNIT:mm

DESCRIPTION:

MINI PCI EXPRESS SOCKET, H=4.0mm, BLACK, GOLD FLASH, (RoHS)

PRODUCT NO.

MPCIH1-052NG1R-COD

FILE NAME.

NO.	PART NAME	DESCRIPTION
3	HOLDDOWN	Brass C2680, Tin Plated
2	CONTACT	Phosphor Bronze C5210, Contact Area: Gold Flash Over Nickel
1	HOUSING	LCP UL94V-0, Black



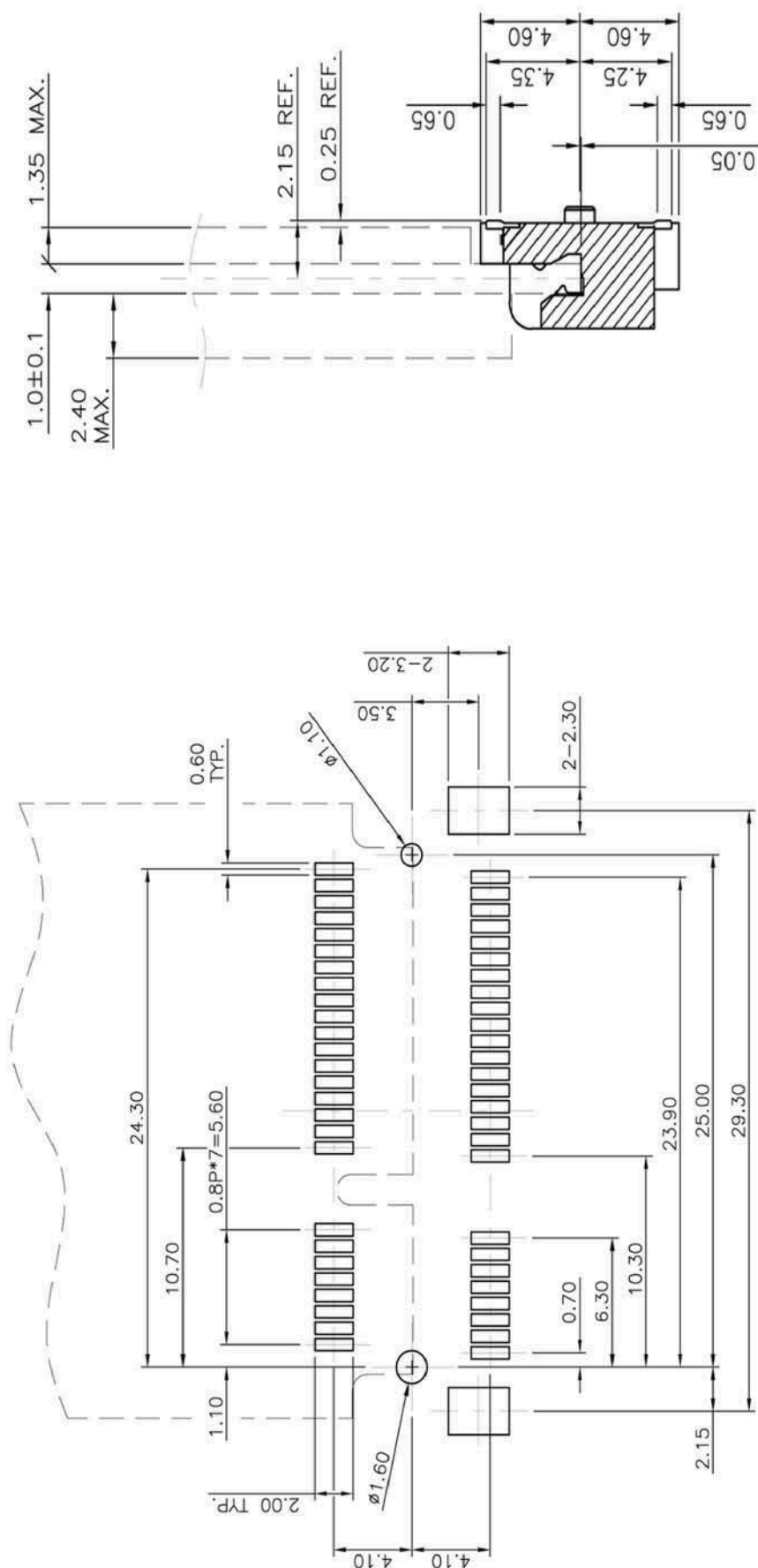

RECOMMEND PCB LAYOUT, TOP VIEW

- IS CARD
- IS PAD LAYOUT

GENERAL TOLERANCE: ±0.05

GENERAL TOLERANCE

SIZE	A4	DRAWN	Sarm
REV.	0	DATE	08/11/15

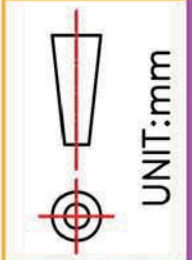

UNIT:mm

DESCRIPTION:

MINI PCI EXPRESS SOCKET, H=4.0mm, BLACK,
GOLD FLASH, (RoHS)

PRODUCT NO.

MPC/HIS1-052NG1R-C0D

FILE NAME.

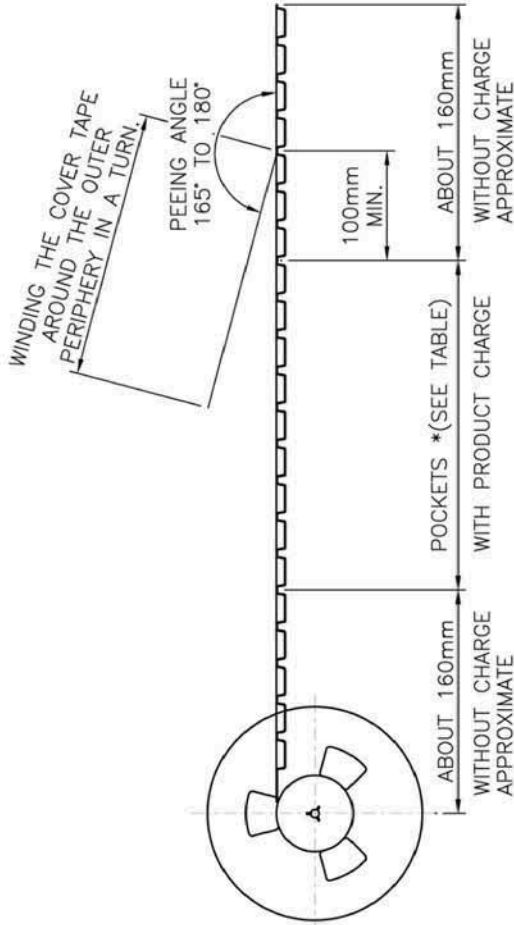
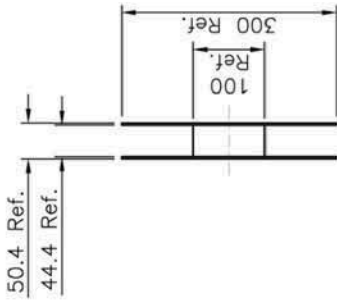

POCKETS *(SEE TABLE)
WITH PRODUCT CHARGE
WITHOUT CHARGE
APPROXIMATE

ABOUT 160mm
WITHOUT CHARGE
APPROXIMATE

NOTE:

1. PEELING RESISTANCE: 0.1N~0.13N (10gf~130gf)
PEELING ANGLE: 165°~180°
PEELING SPEED: 300mm/min.

2. PACKING STYLE
6 REEL/CARTON

PACKING TABLE		
Q'TY/ REEL	Q'TY/ CARTON	
700 PCS	4,200 PCS	

REEL DIMENSIONS
SCALE 1/10

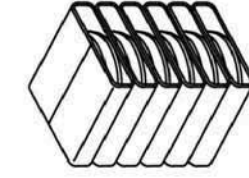
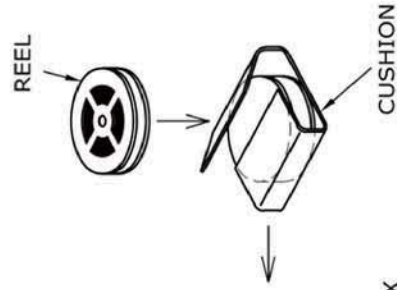
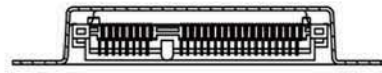
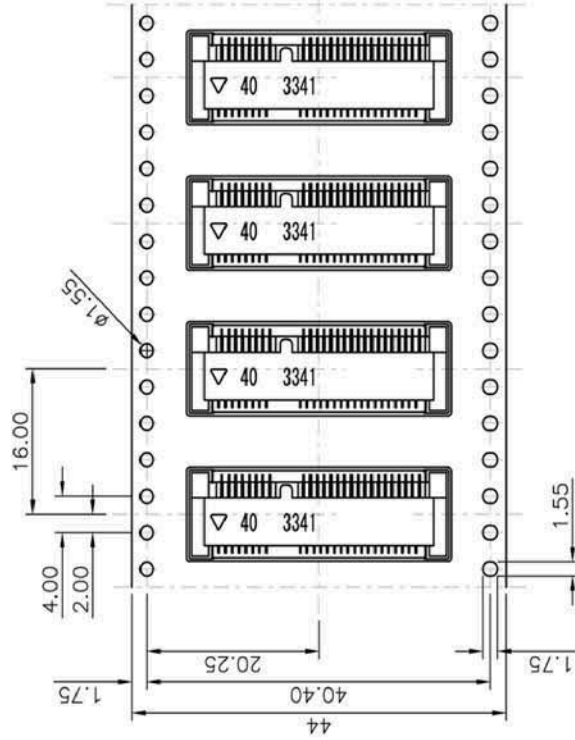

6 REEL IN BOX

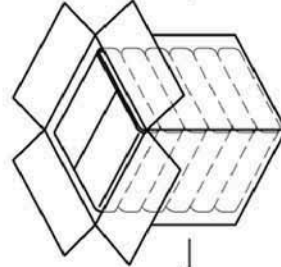

BOX PACKING

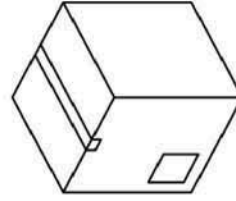

OUTER BOX



GENERAL TOLERANCE

DECIMAL	LINEAR	ANGLES
X.	±0.50	±5°
X.X	±0.25	±3°
X.XX	±0.12	±1°

SIZE

A4	Drawn
REV. 0	DATE 08/11/15

DESCRIPTION:

MINI PCI EXPRESS SOCKET, H=4.0mm, BLACK,
GOLD FLASH, (RoHS)

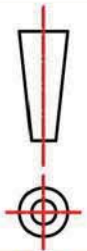

UNIT:mm

PRODUCT NO.

MPC/HIS1-052NG1R-C0D

FILE NAME.

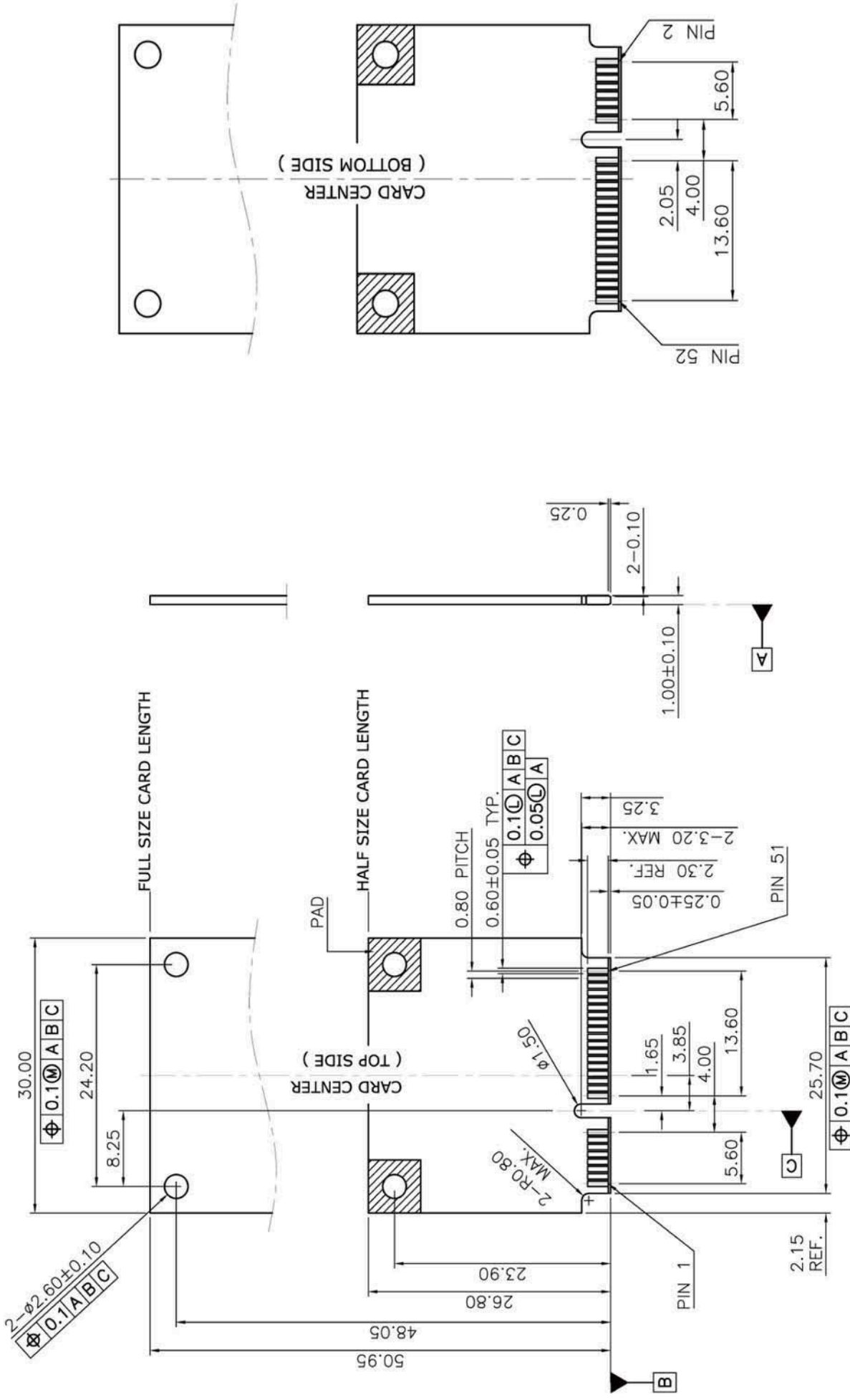

PRODUCT NO. MPC/HIS1-052NG1R-C0D
FILE NAME.

DESCRIPTION:
MINI PCI EXPRESS SOCKET, H=4.0mm, BLACK,
GOLD FLASH, (RoHS)

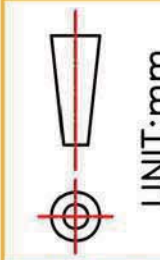

GENERAL TOLERANCE	SIZE	DRAWN	DATE
DECIMAL	A4	Sarm	08/11/15
X.	REV.	DATE	
X.X	0		
X.XX			

GENERAL TOLERANCE	SIZE	DRAWN	DATE
DECIMAL	A4	Sarm	08/11/15
X.	REV.	DATE	
X.X	0		
X.XX			

GENERAL TOLERANCE	SIZE	DRAWN	DATE
DECIMAL	A4	Sarm	08/11/15
X.	REV.	DATE	
X.X	0		
X.XX			

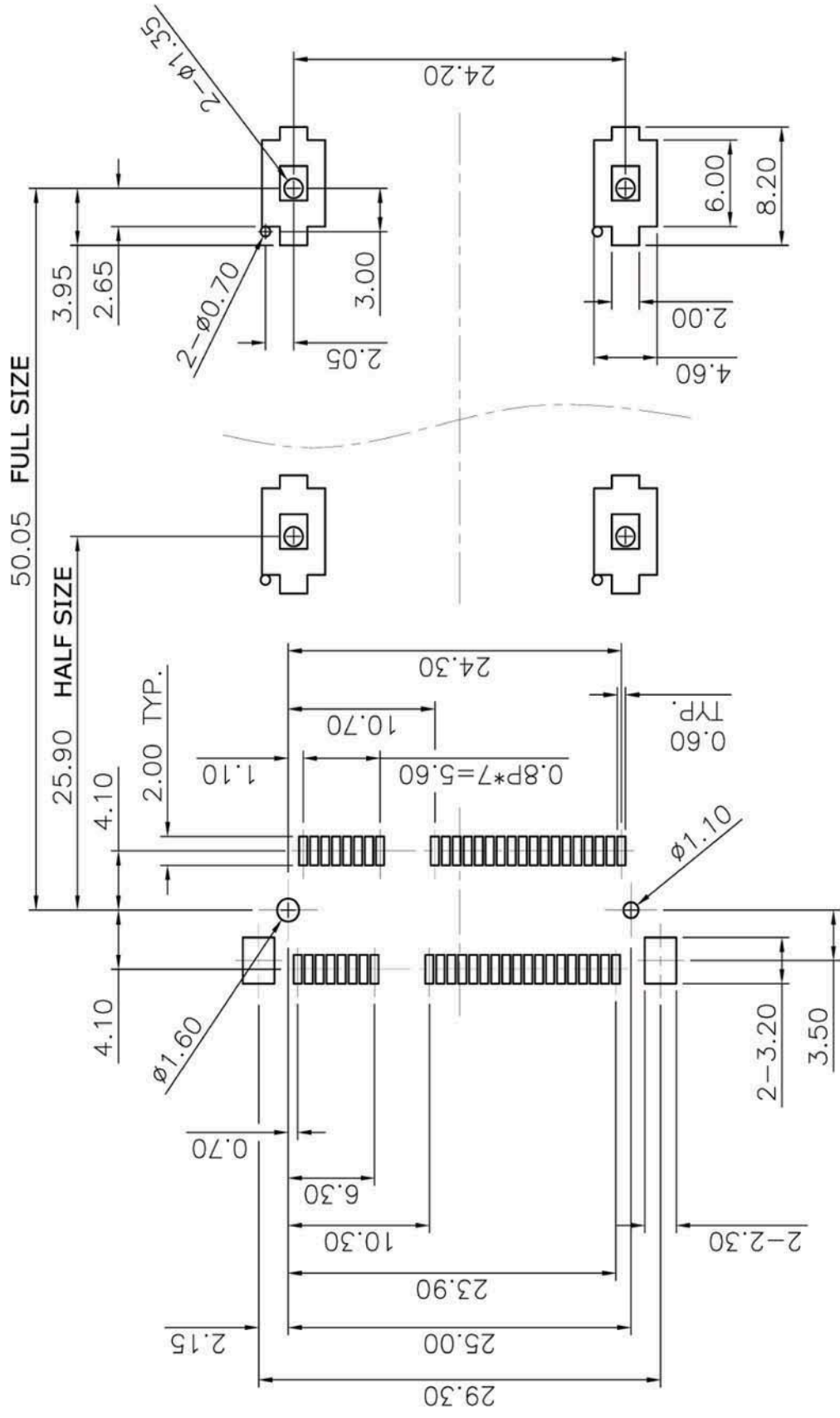

GENERAL TOLERANCE: ±0.05mm

GENERAL TOLERANCE

DECIMAL	LINEAR	ANGLES
X.	±0.50	±5°
X.X	±0.25	±3°
X.XX	±0.12	±1°

SIZE	DRAWN
A4	Sarm
REV.	DATE
0	08/11/15

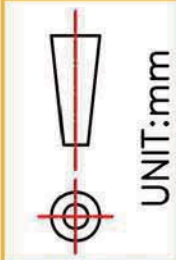

DESCRIPTION:
 MINI PCI EXPRESS SOCKET, H=4.0mm, BLACK,
 GOLD FLASH, (RoHS)

PRODUCT NO.
 MPC/HIS1-052NG1R-C0D

FILE NAME.